

Outdoor Unit: PURY-P216TSHMU-A – DIMENSIONS

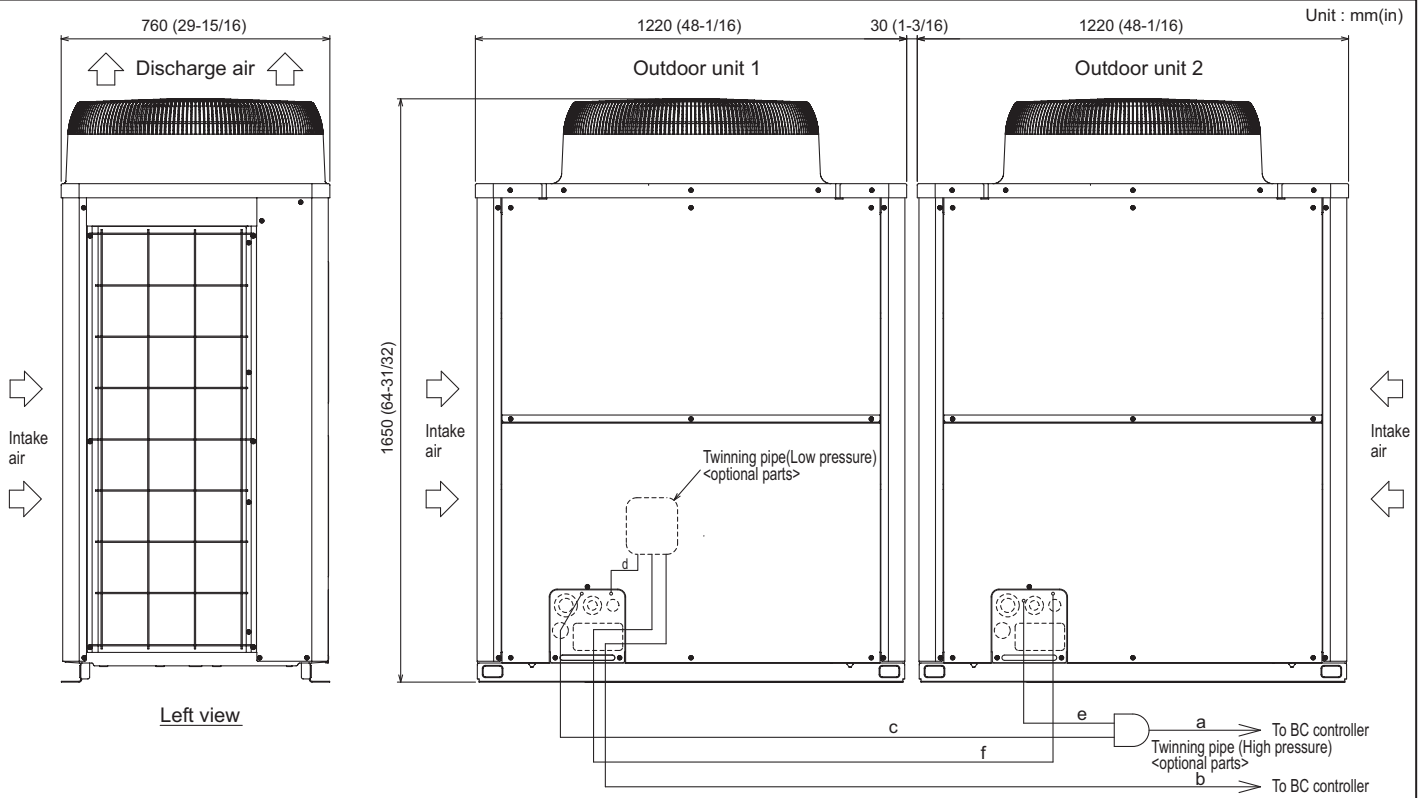

Twinning pipe connection size

Package unit name		PURY-P192TSHMU-A(-BS)	PURY-P216TSHMU-A(-BS)	PURY-P240TSHMU-A(-BS)
Component unit name	Outdoor unit 1	PURY-P96THMU-A(-BS)	PURY-P120THMU-A(-BS)	PURY-P120THMU-A(-BS)
	Outdoor unit 2	PURY-P96THMU-A(-BS)	PURY-P96THMU-A(-BS)	PURY-P120THMU-A(-BS)
Outdoor Twinning Kit(optional parts)		CMY-R100VBK		
BC controller ~ Twinning pipe	High pressure	a	ø22.2(7/8)	ø28.58(1-1/8)
	Low pressure	b	ø28.58(1-1/8)	

	Unit model	High pressure	Low pressure
		c or e	d or f
Twinning pipe ~ Outdoor unit	P96	ø19.05(3/4)	ø22.2(7/8)
	P120	ø19.05(3/4)	ø28.58(1-1/8)

- Note 1. Connect the pipes as shown in the figure above. Refer to the table above for the pipe size.
 2. Twinning pipe (high pressure) should not have a side-to-side angle of more than 15 degrees.
 3. Refer to the Installation Manual for details of the Twinning pipe installation.
 4. The straight length of piping before the Twinning pipe (section "a" in the figure) must be at least 500mm(19-11/16) (*including the straight pipe supplied with the Twinning pipe).
 5. Use only the Twinning pipes manufactured by Mitsubishi (optional parts).

Twining Kit: CMY-R100VBK

CMY-R100VBK

Low-pressure pipe twining kit

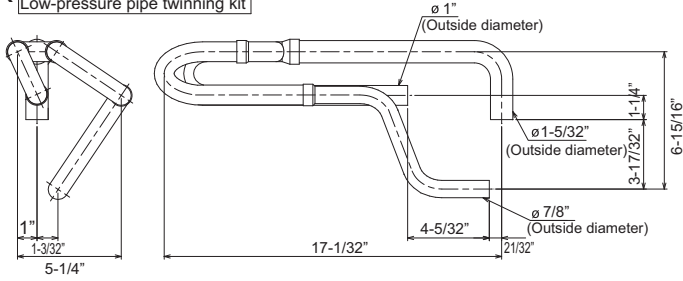

<Elbow pipe (Accessory)>

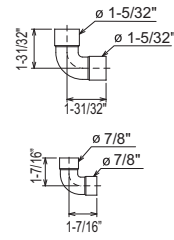

<Low-pressure pipe twining kit (Accessory)>

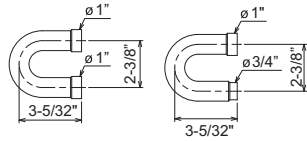

<Reducer pipe (Accessory)>

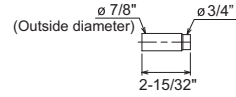

High-pressure twining pipe

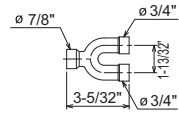

<Pipe for routing through the bottom (Accessory)>

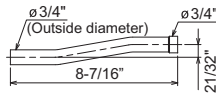

<Pipe for routing through the front (Accessory)>

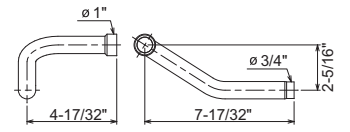
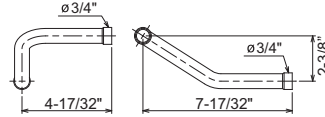

<Reducer pipe (Accessory)>

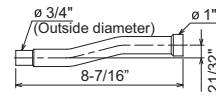
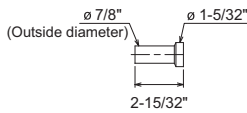
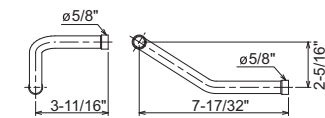
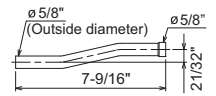
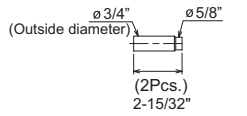

For instructions on piping the units together using the twining kit, see the Installation Manual.

Modules 1 and 2: PURY-P120THMU-A and PURY-P96THMU-A – DIMENSIONS

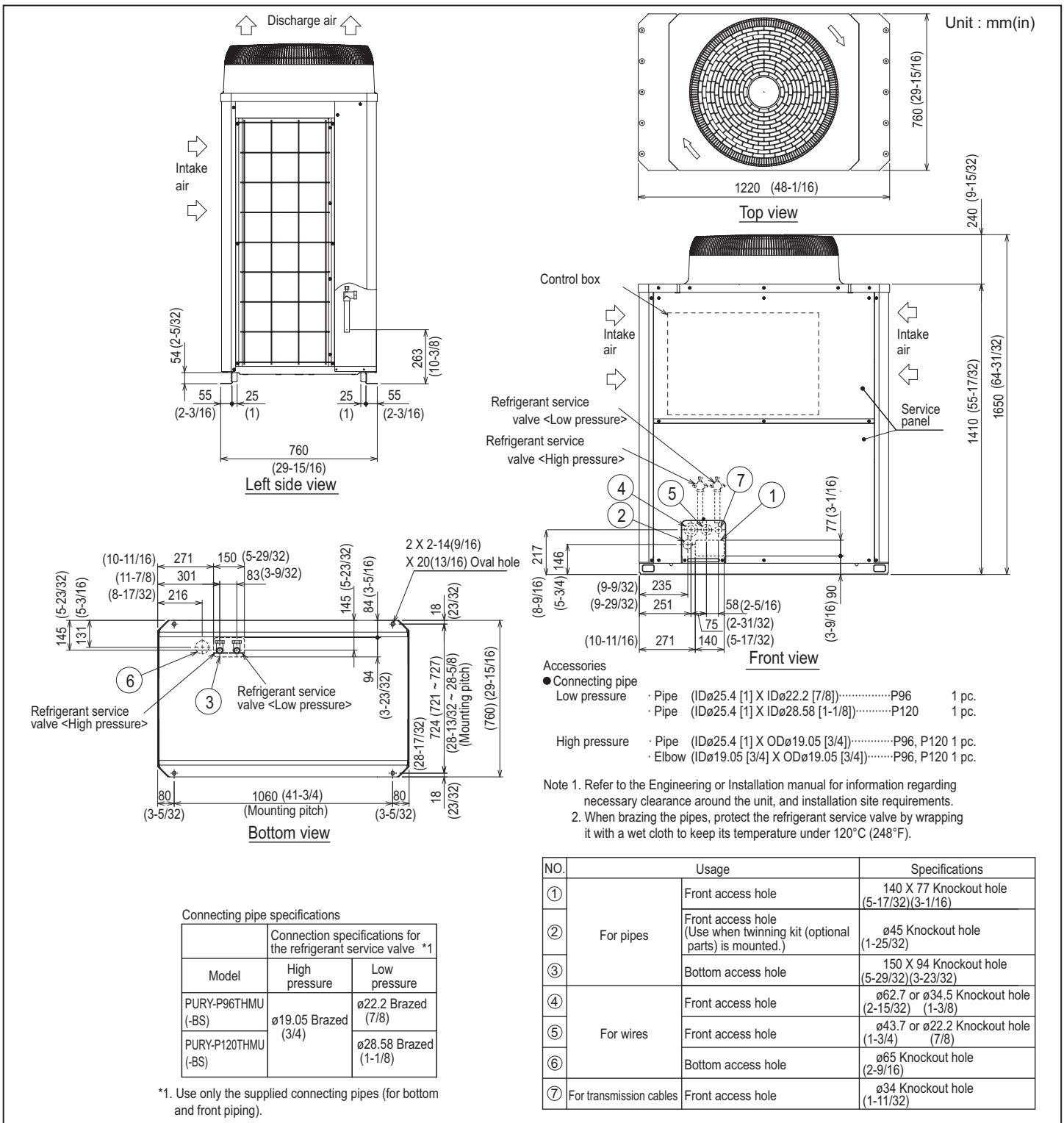

Mitsubishi Electric Air Conditioning & Refrigeration Systems Works acquired ISO 9001 certification under Series 9000 of the International Standard Organization (ISO) based on a review of quality warranties for the production of refrigeration and air conditioning equipment.

ISO Authorization System
 The ISO 9000 series is a plant authorization system relating to quality warranties as stipulated by the ISO. ISO 9001 certifies quality warranties based on the "design, development, production, installation and auxiliary services" for products built at an authorized plant.



HVAC Advanced Products Division
 Mitsubishi Electric & Electronics USA, Inc.

3400 Lawrenceville Suwanee Rd.
 Suwanee, GA 30024
 Tele: 678-376-2900 • Fax: 800-889-9904
 Toll Free: 800-433-4822 (#4)
 www.mehvac.com



Mitsubishi Electric Air Conditioning & Refrigeration Systems Works acquired environmental management system standard ISO 14001 certification.

The ISO 14000 series is a set of standards applying to environmental protection set by the International Standard Organization (ISO).